

**PATTERN FOR CORRECT INSTALLATION OF THE FILTER**

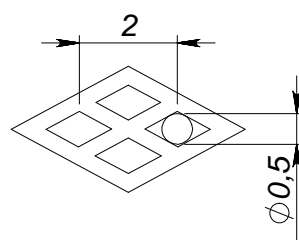
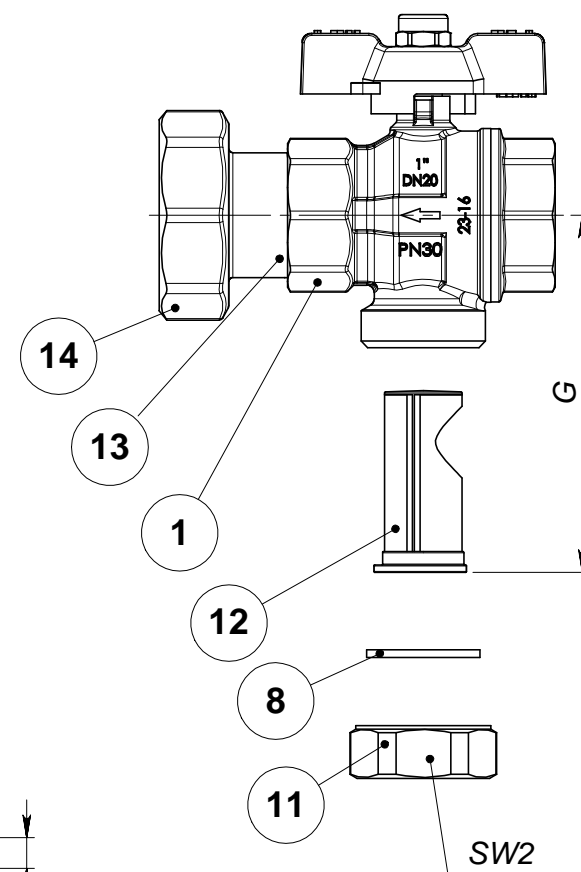
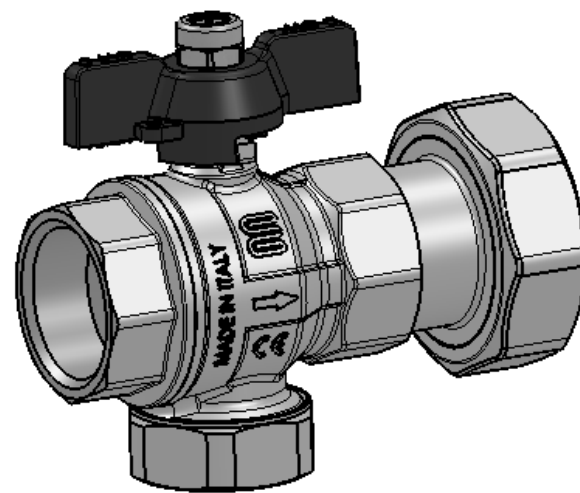
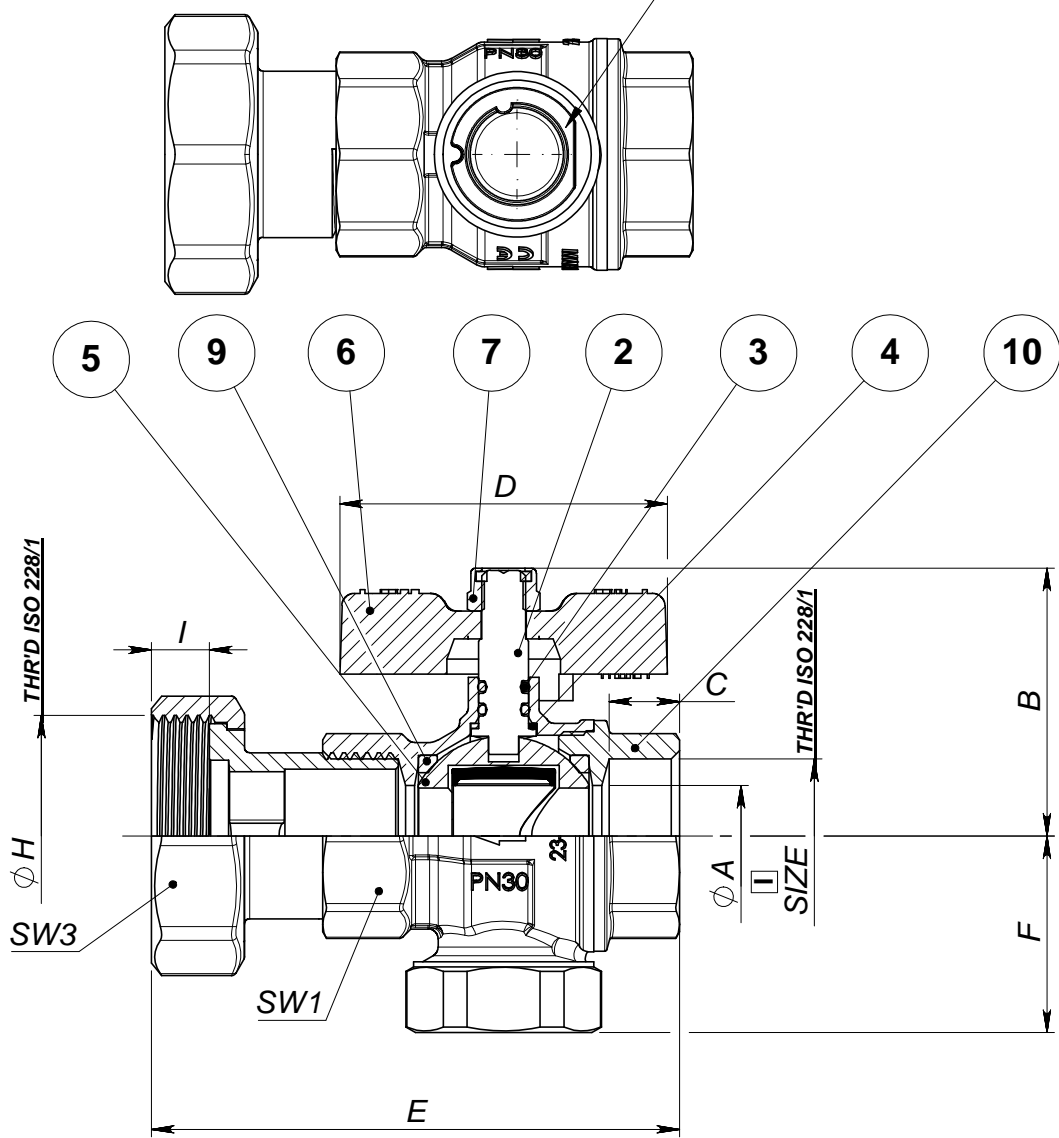

SIZE	STEP OF HOLES	SIZE HOLES IN mm	NUMBER OF HOLES IN cm2	PERCENTAGE EMPTY ON FULL	SHEET THICKNESS
1"	2	0.5	80	48%	0.25

RPE1700031	1"	20	20	53	12.5	65	105	39	87	1 1/2	11.5	38	36	52	30
CODICE - CODE	MISURA - SIZE	DN	Ø A	B	C	D	E	F	G	Ø H	I	SW1	SW2	SW3	PN

**CARATTERISTICHE - FEATURES**

CARATTERISTICHE - FEATURES		ASSEMBLY & TESTING SPECS	N°	DESCRIPTION	MATERIAL	N° PIECES
DIREZIONE FLUSSO - FLOW DIRECTION	IN THE SENSE OF THE ARROW	EGA.004	1	BODY	CW617N (EGM.001)	1
MANOVRA - OPERATION	STEM ROTATION OF 90°	EGA.006	2	STEM	CW614L(EGM.002)	1
ESTREMITA' - ENDS	FEMALE/FEMALE ISO 228/1	EGA.009	3	O-RING	HNBR(EGM.051)	2
DISPOSITIVO BLOCCAGGIO - LOCKING DEVICE		EGA.016	4	THRUST WASHER	PTFE (EGM.009)	1
SIGILLANTE - SEAL	LOCTITE AVX (EG.022)		5	BALL	CW617N(EGM.001)	1
LUBRIFICANTE - LUBRICANT	GREASE (EGM.025)		6	RED T-HANDLE	ALLUMINIUM(EGM.006)	1
LIMITI DI PRESSIONE - PRESSURE LIMITS	SEE TAB		7	SELF-LOCKING NUT	STEEL (EGM.020)	1
LIMITI DI TEMPERATURA - TEMPERATURE LIMITS	from -20°C to +100°C	EGP.015	8	GASKET	NBR (EGM.070)	1
IMPIEGHI - SERVICES	HOT AND COLD WATER, FOR HEATING SYSTEM	EGP.016	9	BALLGASKETS	PTFE (EGM.009)	2
			10	END-ADAPTER	CW617N(EGM.001)	1
			11	CAP	CW617N(EGM.001)	1
			12	STRAINER	AISI 304(EGM.037)	1
			13	TAIL	CW617N(EGM.001)	1
			14	NUT	CW617N(EGM.001)	1
NORME DI RIFERIMENTO - SPECIFICATION N°	EN 12164/65 - 97/23 CE - ISO 228/1					

D	E	F												
A	B	C												
Simb	Data	N° Mod.	Firma	Approvato	Simb	Data	N° Mod.	Firma	Approvato	Simb	Data	N° Mod.	Firma	Approvato

Sostituisce il: \_\_\_\_\_

Sostituito dal:  1  2  3

Contrassegno di Sicurezza

Tolleranze Generali da applicare: ± 1

TOLLERANZE PER LAV. MECCANICHE norma EGD.002

QUOTE	>	0	30	80	150	ANGOLI	CONCENTRICITA'	SMUSSI
mm	=	30	80	150	250	°	0,2	0,2x45°

RUGOSITA'

12.5 Q=12,5 micron (Stampaggio)

3.2/√=3,2 micron (Tomitura)

0.8/√=0,8 micron (Diamantatura)

Stato: ASSEMBLED

Materiale: VARIOUS

Trattamento: NICKEL-PLATED

Disegnato: CEBAN ION

Approvato:

Data: 07/06/2017

Scala: 2:3

Particolare: BALL VALVE WITH TAIL AND NUT FEMALE/ FEMALE THR'D ISO 228/1, RED T-HANDLE, WITH FILTER

Serie: BASIC

Misura: 1"

N° Cod. RPE1700031



CONCESIO Via Europa, 227 ITALY

DISEGNO ESEGUITO AL CAD

Formato A3

Questo disegno non puo' essere usato in nessun modo, ne' essere reso noto a terzi, senza previa autorizzazione scritta della ENOLGAS BONOMI s.p.a.

This drawing must not be used in any manner unless prior written authority is received from ENOLGAS BONOMI s.p.a.